

WL-16RPR130 DC PLANETARY GEAR MOTOR

基本电压/Main Voltage : 3VDC、6VDC

典型应用/Typical Applications :

光学仪器、监控摄像机、节能设备、节水设备、IC水卡、玩具和礼品、办公设备、家用电器、自动化设备。

Optical instrument, Surveillance cameras, Automated energy efficiency, Water saving equipment, IC water card, Toys and gifts, Office equipment, Household appliance, automation equipment

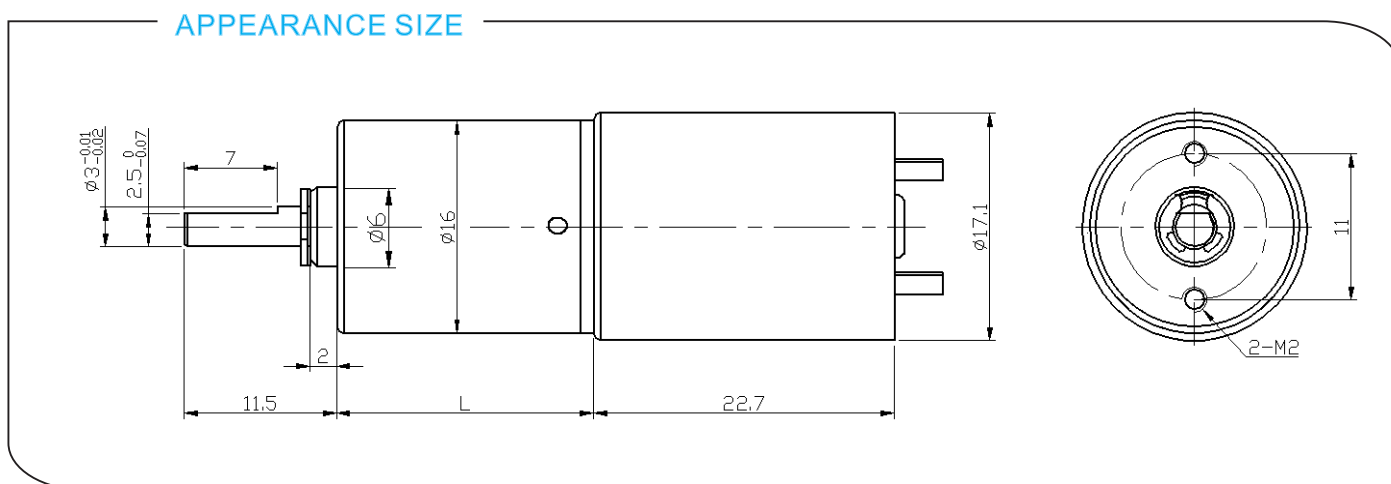

减速箱参数/Gearbox Data:

级数 Number of stages	1	2	3	4	5
减速比 Reduction ratio	4、4.75	16、19、22.5	64、76 90、107	256、304、361 428、509	1024、1216、1444 1714、2036、2418
减速箱长度 Gearbox length "L" mm	12.2	15.8	19.4	23	26.6
破坏扭矩 Breaking torque(kgf.cm)	2	3	4	5	5
减速箱效率 Gearbox efficiency	90%	81%	73%	65%	59%

电机参数/Driving Motor Data:

电机型号 Motor model	额定电压 Rated Volt.	空载/No load		负载/Load				堵转/Stall	
		电流 Current	转速 Speed	电流 Current	转速 Speed	扭矩 Torque	输出功率 Output power	扭矩 Torque	电流 Current
		V	mA	r/min	mA	r/min	g.cm	W	g.cm
WL-R130-1.5-9200	1.5	≤170	9200	≤800	7600	7	0.5	≥30	≥2500
WL-R130-3.5-4700	3.5	≤35	4700	≤135	3700	4.9	0.2	≥19	≥320
WL-R130-4.5-9000	4.5	≤85	9000	≤150	8500	2	0.2	≥28	≥680
WL-R130-006-8100	6	≤45	8100	≤200	6800	7	0.5	≥30	≥560

备注/Remark:

齿轮减速箱额定扭矩 = 电机额定扭矩 * 减速比 * 减速箱效率

Gear Motor Torque = Driving motor torque * Reduction ratio * Gearbox efficiency;

齿轮减速箱额定转速 = 电机额定转速 / 减速比

Gear Motor Speed = Driving motor speed / Reduction ratio

电机具体配置可根据客户的要求进行定制，像电压，速度，以及轴的长度和形状...

Motor detailed config can be customized according to customer's requests,

like voltage, speed, as well as shaft length and shape...

欢迎OEM或OWL项目

Welcome OEM or OWL projects

减速电机样品数据/Geared Motor Samples Data :

电机型号 Motor model	额定电压	空载/No load		负载/Load				堵转/Stall	
	Rated Volt.	电流 Current	转速 Speed	电流 Current	转速 Speed	扭矩 Torque	输出功率 Output power	扭矩 Torque	电流 Current
	V	A	r/min	A	r/min	kgf.cm	W	kgf.cm	A
DM-16RPR1304.59000-256K	4.5	0.09	33.1	0.29	24.6	1.36	0.35	5.3	0.89

曲线图/Curve Chart :

Model: WL-16RPR1304.59000-256K

