

# WL-37RS3540 DC SPUR GEAR MOTOR

基本电压/Main voltage : 6VDC、12VDC、24VDC

典型应用/Typical applications :

仪器仪表、电动工具、咖啡机、自动售卖机、按摩器、游戏机、  
推窗器、自动化设备

Instrument, Electric tools, Coffee machine,  
Vending machine, Massager, Game machine,  
Electric window opener, Automation equipment

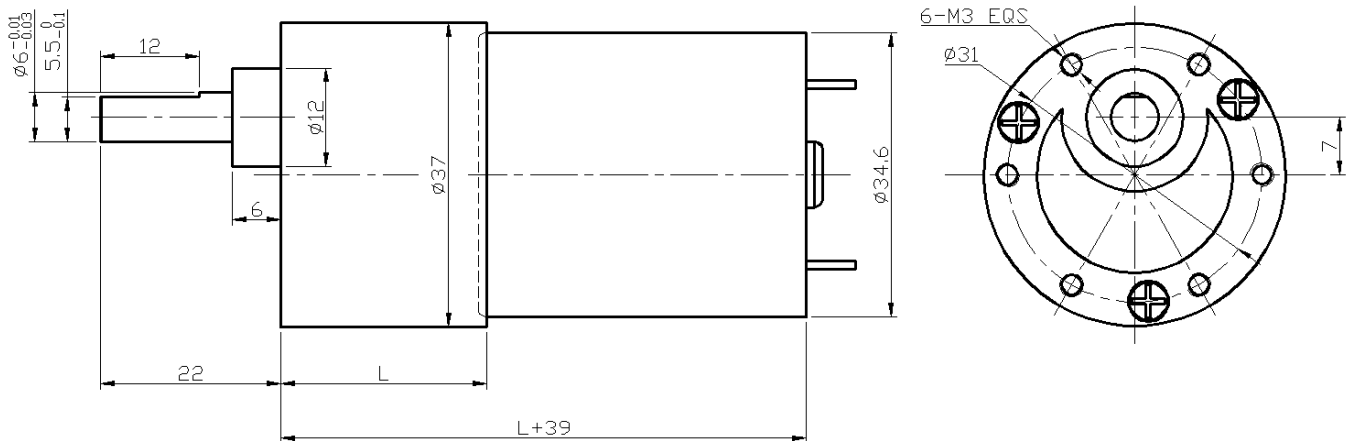

## Gearbox Data :

Number of stages	2	3	4	5	6	7
Reduction ratio	6.8、10	20、30	61、90	122、184、270	311、414、534 552、810	1243、1656 2430
Gearbox length "L"mm	19	22.5	25	27.5	30	31.5
Breaking torque(kgf.cm)	8	10	30	30	40	40
Gearbox efficiency	81%	73%	65%	59%	53%	48%

## Driving Motor Data :

Motor model	Rated Volt.	No load		Load				Stall	
		Current	Speed	Current	Speed	Torque	Output power	Torque	Current
	V	mA	r/min	mA	r/min	gf.cm	W	gf.cm	mA
WL-3540-012-3000	12	$\leq 50$	3000	$\leq 300$	2200	60	1.4	$\geq 240$	$\geq 800$
WL-3540-012-4500	12	$\leq 70$	4500	$\leq 500$	3300	70	2.4	$\geq 500$	$\geq 2000$
WL-3540-012-6000	12	$\leq 100$	6000	$\leq 700$	4500	80	3.7	$\geq 600$	$\geq 2500$
WL-3540-024-3000	24	$\leq 25$	3000	$\leq 150$	2200	60	1.4	$\geq 220$	$\geq 500$
WL-3540-024-4500	24	$\leq 35$	4500	$\leq 250$	3300	70	2.4	$\geq 240$	$\geq 800$
WL-3540-024-6000	24	$\leq 50$	6000	$\leq 350$	4500	80	3.7	$\geq 550$	$\geq 1400$

## Geared Motor Data :

电机型号 Motor model	额定电压 Rated Volt.	空载/No load		负载/Load				堵转/Stall	
		电流 Current	转速 Speed	电流 Current	转速 Speed	扭矩 Torque	输出功率 Output power	扭矩 Torque	电流 Current
	V	A	r/min	A	r/min	kgf.cm	W	kgf.cm	A
WL-37RS35400066000-61K	6.0	0.13	92.0	0.65	74.1	1.9	1.49	10.1	2.84
WL-37RS35400067000-121K	6.0	0.17	55.3	0.62	43.3	2.6	1.19	12.4	2.25
WL-37RS35400068000-61K	6.0	0.26	130.9	1.35	107.4	3.0	3.39	17.2	6.35
WL-37RS35400123000-30K	12.0	0.03	100.4	0.13	84.3	0.9	0.84	6.0	0.68
WL-37RS35400123000-90K	12.0	0.04	32.7	0.16	27.1	2.7	0.76	16.0	0.73
WL-37RS35400123500-552K	12.0	0.04	5.9	0.17	5.1	14.4	0.75	98.9	1.02
WL-37RS35400124000-30K	12.0	0.05	127.9	0.26	103.3	1.2	1.28	6.2	1.14
WL-37RS35400124500-30K	12.0	0.05	143.3	0.29	119.4	1.4	1.76	8.6	1.49
WL-37RS35400124500-90K	12.0	0.07	50.5	0.34	41.4	4.2	1.81	23.5	1.56
WL-37RS35400126000-30K	12.0	0.09	199.0	0.57	169.6	1.9	3.38	13.0	3.34
WL-37RS35400126000-61K	12.0	0.06	91.2	0.44	76.8	2.5	1.97	15.8	2.43
WL-37RS35400128000-810K	12.0	0.11	9.2	0.47	7.4	22.7	1.73	117.2	2.00
WL-37RS35400246000-61K	24.0	0.04	96.0	0.25	81.8	3.1	2.64	21.2	1.41
WL-37RS35400246000-184K	24.0	0.07	33.1	0.34	26.4	10.85	2.94	53.5	1.38
WL-37RS35400246000-534K	24.0	0.08	10.8	0.30	8.8	23.83	2.15	128.0	1.24
WL-37RS35400247000-20K	24.0	0.04	336.1	0.24	294.9	0.94	2.86	7.7	1.66
WL-37RS35400247000-121K	24.0	0.03	57.1	0.20	50.0	4.31	2.21	34.6	1.36
WL-37RS35400247000-184K	24.0	0.09	35.0	0.39	28.2	12.00	3.47	61.7	1.64

## Curve Chart :

Model: WL-37RS35400126000-30K

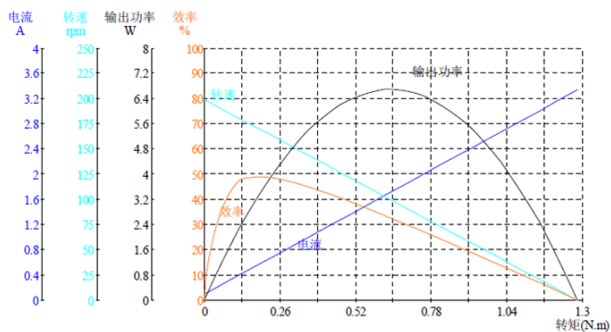

Model: WL-37RS35400126000-61K

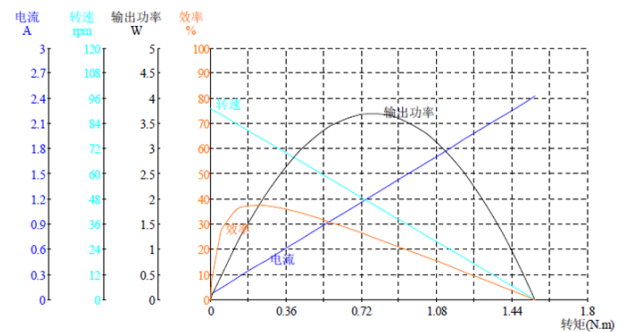

## **Remark:**

**Gear Motor Torque=Driving motor torque\*Reduction ratio\*Gearbox efficiency;  
Gear Motor Speed=Driving motor speed/Reduction ratio**

**Motor detailed config can be customized according to customer's requests,  
like voltage,speed,as well as shaft length and shape...**

**Welcome OEM or OWL projects**